

SEVERE DUTY SLURRY PUMPS

K-HS™ HORIZONTAL PUMP



KETO PUMPING SOLUTIONS - SUPERIOR PERFORMANCE EVEN IN THE MOST DEMANDING APPLICATIONS

KETO PUMPS VERSATILE SOLUTIONS

KETO K-HS™ pump range includes severe duty horizontal slurry pumps designed to handle the transfer of the most severe corrosive and abrasive slurry applications. K-HS™ pumps feature patented innovative designs that can significantly reduce the operational costs of slurry pumping.

Reliable operation is paramount, our pumps are cast from high quality heavy duty materials of construction to ensure long term wear resistance and great performance. With a range of genuine wet end parts and different material combinations the K-HS™ slurry pumps have the versatility to ensure the most appropriate pumping solution can be provided for any given application.

TECHNICAL DATA

- **Range from:** 25 mm (1") to 500 mm (18")
- **Flow rates to:** 7,300 m³/hr (32,144 USgpm)
- **Total head to:** 110 m (361 ft)
- **Pressures to:** 2,100 kPa (305 psi)
- **Material options:** chrome iron, rubber, urethane
- Specialist materials available on request for highly acidic or caustic duties

TYPICAL APPLICATIONS

- Mineral processing
- Chemical processing
- Coal preparation
- Effluent handling
- Gravel & sand



KETO K-HS™ SLURRY HORIZONTAL PUMP

- FEATURES & BENEFITS

1 HEAVY DUTY BASE

- Heavy duty one piece frame with lifting points for easy maintenance

2 K-IBA™ HEAVY DUTY BEARING ASSEMBLY

- Easy to maintain cartridge style bearing assembly
- Modern bearing seals for increased reliability
- Patented grease and oil flinger allows a simple choice of oil or grease lubrication
- Bearing assembly can be replaced in-situ
- Various material options available including carbon steel and stainless steel

3 SINGLE PIECE SLEEVES

- Single piece allows for easy maintenance and removal
- Sleeves are available in ceramics or metal, including our solid Karbide™ shaft sleeve for long wear life
- Extended replacement intervals
- O-ring seals protect from abrasive/corrosive contaminants
- Expanded sealing options

4 K-HEE™ SEVERE DUTY HIGH EFFICIENCY IMPELLER

- KETO K-HEE™ reduces throat bush wear
- Improved hydraulics for higher efficiency
- Lower NPSHR and increased wear life
- Superior resistance to recirculating flows, twisted vanes enable better eye inlet conditions, controlling flow paths
- Multi-purpose design allowing reduced inventory requirements

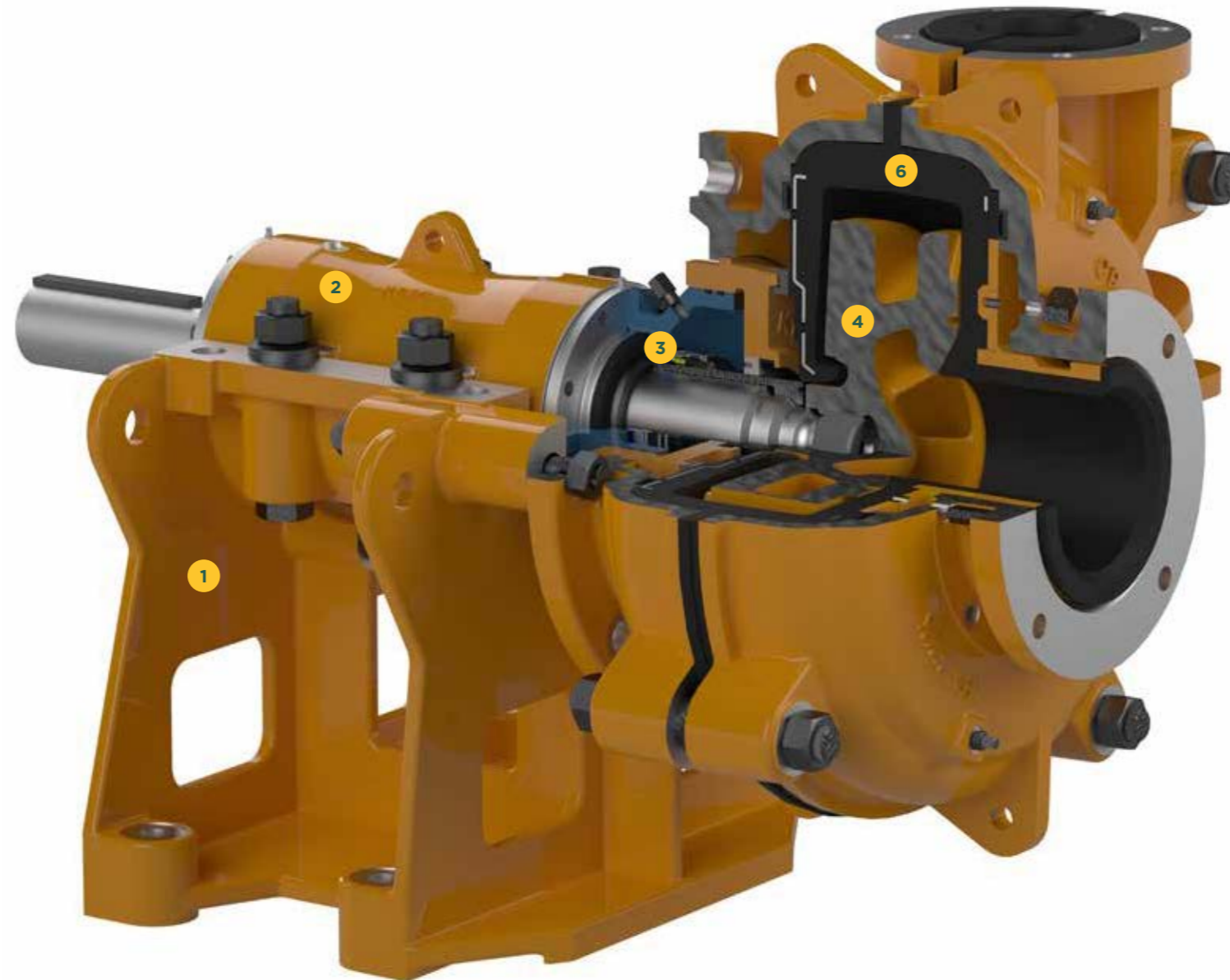

5 K-ISS™ MECHANICAL SEAL (EXTERNAL FLUSH)

- Mechanical seal situated in clean water, not in contact with slurry, significant reduction in wear and reduced inventory
- Requires less maintenance than other sealing options
- Fitted with a flow control valve, low water consumption, available in both single and double seal options
- Hydrocarbon free (gland water barrier fluid)

6 LINERS

- Thick elastomer or metal liners for extended wear life, reliability, superior corrosion resistance and improved hydraulic performance
- Interchangeability and reduced inventory, our MultiFit™ liner can replace five alternate supplier liner designs
- Liners are bolted to allow for quick and easy maintenance
- Separate volute seal allows easier installation of parts
- Cast Lifting Points replace threaded points that corrode over time

7 POLYCARBONATE WINDOW BELT GUARD

- Tool free inspection
- Transparent case allows for easy maintenance and inspection of belt condition

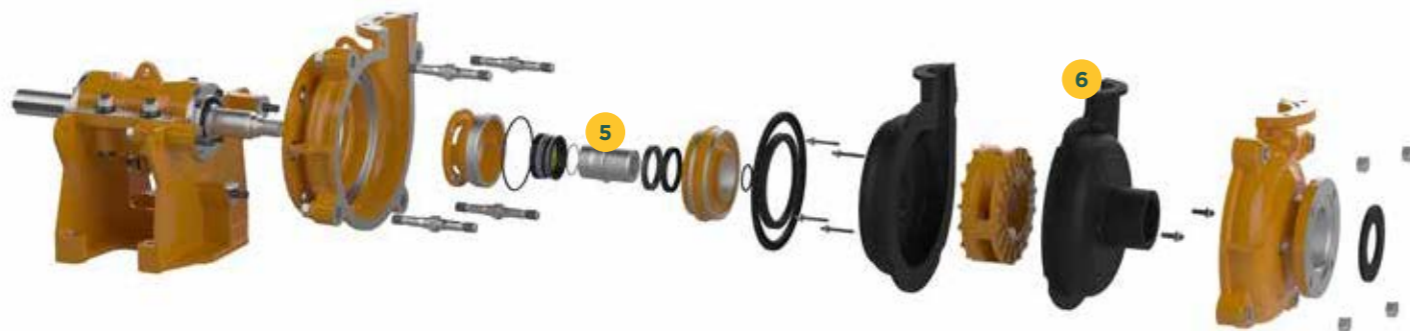

KETO Pumps offer a wide range of configurations allowing the pump to be tailored to a specific application

| | LINERS | IMPELLERS | EXPELLERS | EXPELLER RINGS | SHAFT SLEEVE | SEALS | CASING |
|----------|---|--|------------------------------|------------------------------|---|--------------------------------|------------------|
| STANDARD | Chrome Iron Natural Rubber Polyurethane | Chrome Alloy Natural Rubber Polyurethane | Chrome Alloy Polyurethane | Chrome Alloy Polyurethane | Chrome Alloy Stainless Steels Carbon Steels | Natural Rubber Polyurethane | Ductile Iron |
| OPTIONS | Stainless Steels | Stainless Steels | Stainless Steels | Stainless Steels | Solid Tungsten Carbide | Viton | Stainless Steels |

*Standard range shown above, specialist engineered units are available on request.

STANDARD HYDRAULIC RANGE CHART

K-HS™ HORIZONTAL SLURRY PUMPS RANGE COVERAGE CHART

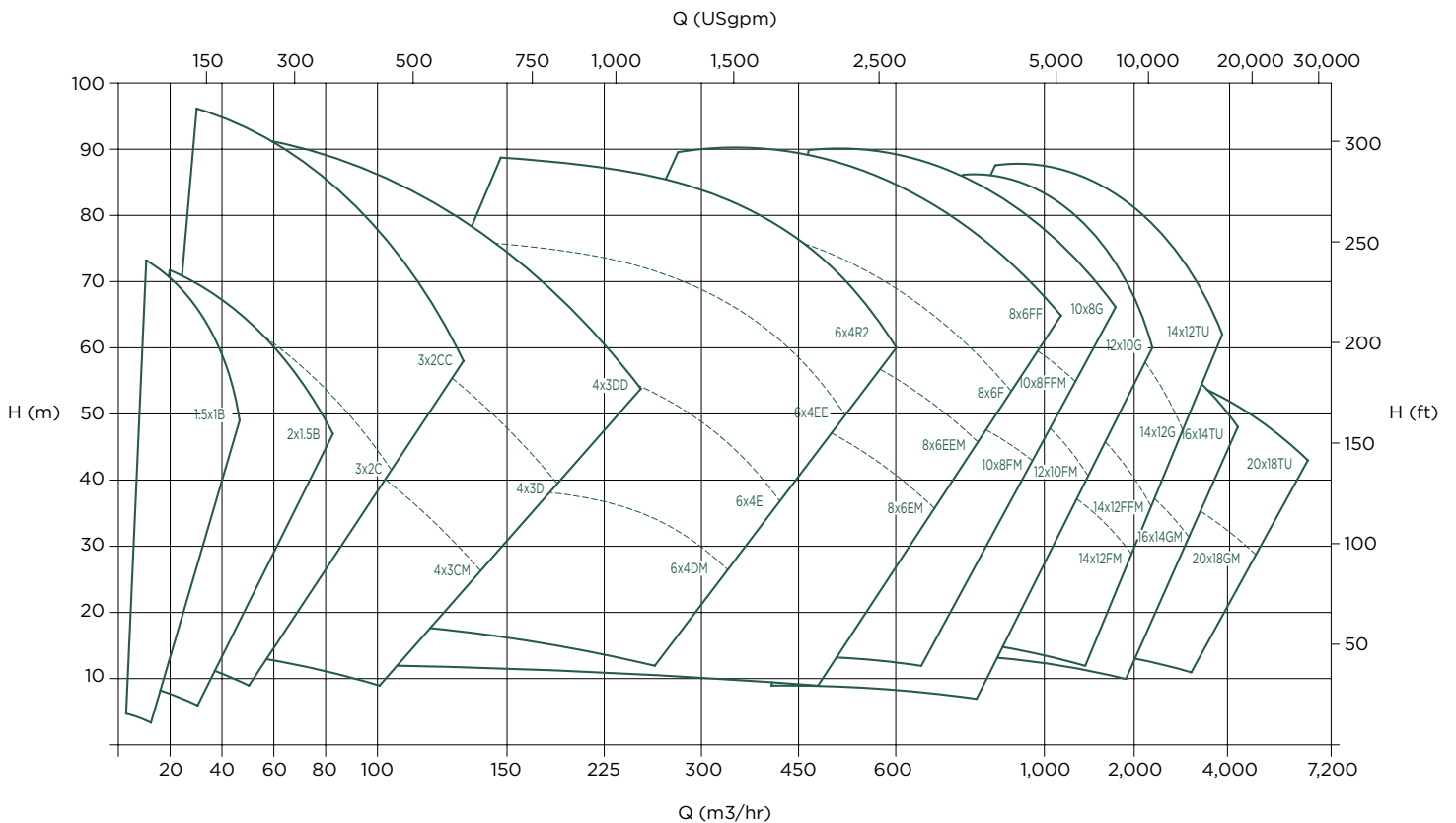

DRIVE ARRANGEMENTS

CR/CL DRIVEN

- For applications where height or overhead spaced is limited

CV DRIVEN

- For applications where floor space or area is limited

ZV DRIVEN

- Used in installations where the selected motor is too large to be CV (overhead) mounted



8 rotations of 45 degrees available on discharge flange for all K-HS™ drive arrangements

FOR MORE INFORMATION PLEASE VISIT KETOPUMPS.COM
OR EMAIL INFO@KETOPUMPS.COM
OR CONTACT US AT ONE OF THE FOLLOWING LOCATIONS

AMERICAS

Email:
americas@ketopumps.com

Jacksonville, FL
Tel: +1 904 404 7169

Tucson, AZ
Tel: +1 520 579 6467

Bakersfield, CA
Tel: +1 661 393 8441

Salt Lake City, UT
Tel: +1 801 972 4372

AFRICA

Email:
africa@ketopumps.com

Johannesburg, South Africa
Tel: +27 86 100 5386

Middelburg, South Africa
Tel: +27 13 246 1970

EUROPE

Email:
europe@ketopumps.com

AUSTRALASIA

Email:
australasia@ketopumps.com

Henderson, WA
Tel: +61 8 9494 8400

ASIA

Email:
asia@ketopumps.com

Beijing, China
Tel: +86 10 6598 9539

KETO pumps reserves the right to incorporate our latest design and material changes without notice or obligation. Copyright © 2018 KETO Pumps

